

DATE: April 23, 2020
TO: Allegan County Chairman and Board of Commissioners
FROM: Denise Medemar, Allegan County Drain Commissioner
RE: 2019 Annual Report

I am pleased to present to you the 2019 Annual Report for the work performed by the Allegan County Drain Commissioner and employees. The Drain Office, as a whole, performs a wide spectrum of duties when it comes to drain maintenance or petitioned projects on drains or lake level projects. A majority of the maintenance projects begin with a telephone call to the Drain Office from a citizen or township with a concern that involves an issue with water. Michigan has recently seen how the frequency and intensity of precipitation has impacted many areas in the State. Annual water totals have increased, interior lakes and streams are seeing greater flows and impact, and the Great Lakes are experiencing record levels. Groundwater is high, causing impact to infrastructure. As a result the Drain Office responded to increased reports from citizens and townships regarding high water levels. Due to the large amount of drains that Allegan County has, our maintenance is more reactive than proactive.

I have attached a few highlights of our 2019 activity:

- Maintenance and Petitioned Projects Completed in 2019
- Projects Active in 2019
- Intercounty Drain Projects Active in 2019
- Rodgers Intercounty Drain
- Wilson Intercounty Drain

Most of the projects that are active in 2019 are in the process of obtaining easements or in the engineering design phase. On August 7, 2019, the Rogers Intracounty Drain and the Wilson Intracounty Drain became Intercounty Drains with Kent County for the Rogers Intercounty Drain and Barry County for the Wilson Intercounty Drain.

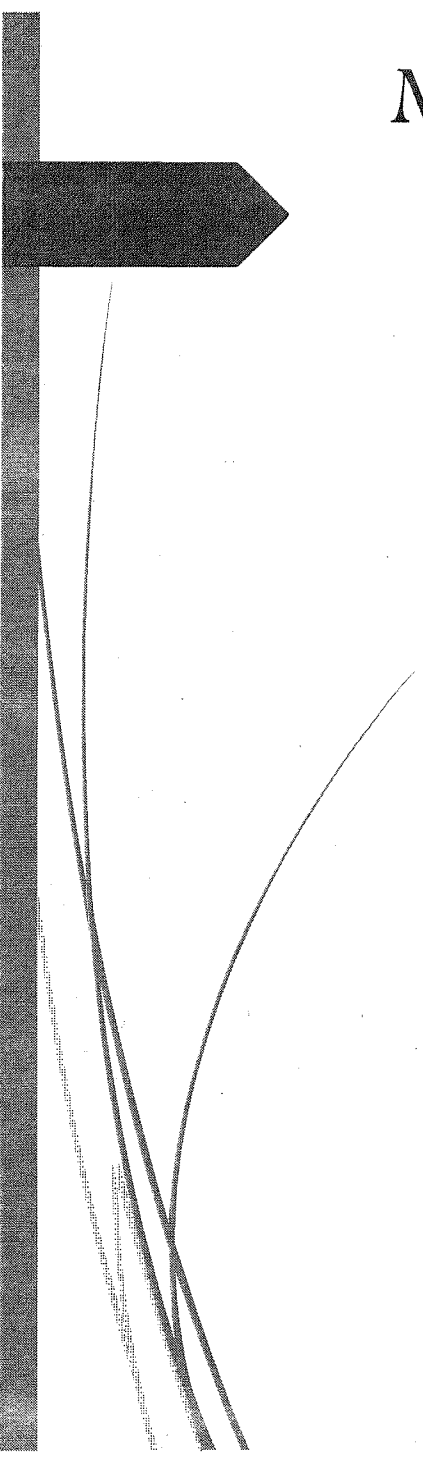

Maintenance & Petitioned Projects Completed in 2019

- ▶ Brainard & Pease-Otsego Township
- ▶ East Fillmore-Fillmore Township
- ▶ Elm Creek-Casco Township
- ▶ Glenn Shores-Casco and Ganges Townships
- ▶ Selkirk Lane-Martin and Wayland Townships



Projects

Active in 2019

- ▶ Baughman Drain-Otsego Township, Otsego City
- ▶ Big Lake Drain-Watson Township
- ▶ Buskirk Drain-Hopkins and Wayland Townships
- ▶ Casco Drain -Casco Township
- ▶ Neerken's Plat-Fillmore Township
- ▶ Secluded Acres Drain-Salem Township
- ▶ Severens Drain-Clyde Township
- ▶ Trowbridge-Cheshire Drain-Allegan, Cheshire, Trowbridge and Valley Townships



Intercounty Drain Projects

Active in 2019

- Base Line Intercounty – Van Buren County
- Baseline Lake Intercounty-Van Buren County
- Black Creek Intercounty – Kent and Ottawa Counties
- Boyd Intercounty-Ottawa County
- Brush Creek Intercounty – Van Buren County
- Byron-Dorr Intercounty – Kent County
- Carpenter Intercounty – Van Buren County
- Cuddy Intercounty – Barry County
- Deal Intercounty – Barry County
- Duncan Lake Intercounty – Barry and Kent Counties
- Gun River Intercounty – Barry County
- Hubbard Intercounty-Kalamazoo County
- Kelly Lake Intercounty – Ottawa County
- Klopfenstein Intercounty-Kent County
- Lane & Griffin Intercounty-Van Buren County
- Maplewood Intercounty-Ottawa County
- Orangeville Creek-Barry County
- Otsego-Alamo Intercounty – Kalamazoo County
- Ottogan Intercounty – Ottawa County
- Reno Intercounty—Barry County
- Rodgers Intercounty-Kent County
- Saddler Intercounty—Barry County
- Sandy Beach Intercounty – Barry County
- Tulip Intercounty – Ottawa County
- Virginia Park Intercount-Ottawa County
- Wilson Intercounty-Barry County
- Winters Intercounty-Kent County

Rodgers Intercounty Drain

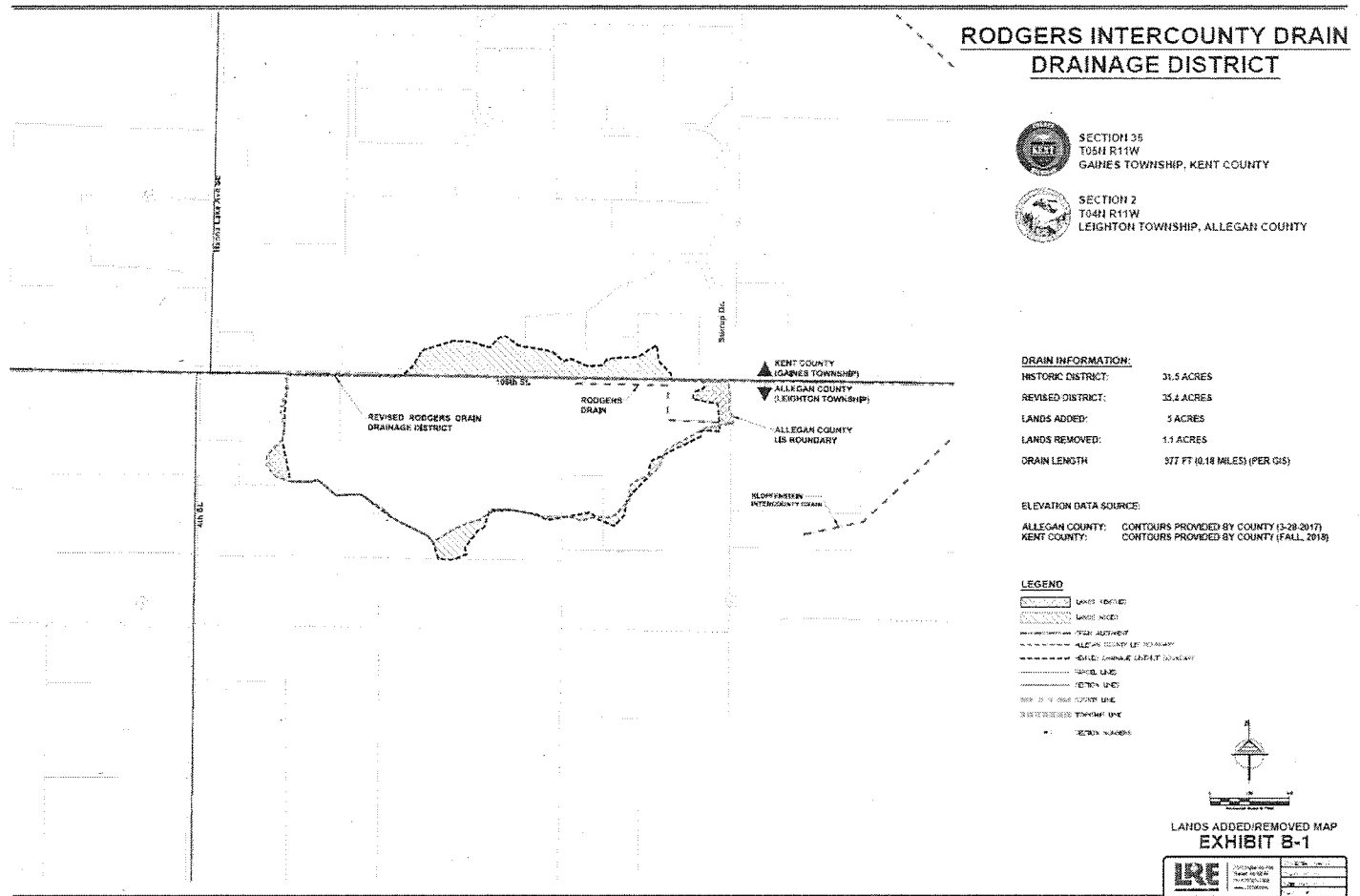



2019 ANNUAL REPORT

Cuddy Intercounty Drain

Wayland Township and Barry County



**TO THE HONORABLE BOARD OF COMMISSIONERS OF THE
COUNTY OF ALLEGAN:**

In compliance with the provision of Section 280.31 of Chapter II, of Act No. 40, of Public Acts of 1956, as amended, I have the honor as the elected Drain Commissioner of said County of Allegan, to submit the 2019 Annual Report covering the period from the 1st day of January, A.D. 2019, to the 31st day of December, A.D. 2019.

2019 Drain Commissioner and Office Staff:

Denise Medemar, Drain Commissioner
Carolynn Parnell, Chief Deputy
Joel Morgan, Deputy Engineer
Brent Scholten, Maintenance Supervisor/Deputy
Clayton Smith, Drain Maintenance
Catherine Boysen, Secretary

2019 ANNUAL REPORT

TABLE OF CONTENTS

The Drain Office

- Drain Maintenance Crew
- Board of Public Works
- Inland Lake Level Projects
- Inland Lake Improvement Boards
- General Developments
- Mobile Home Parks
- Site Condominiums
- Subdivision Developments
- MS4 Permit
- SAW Grant

2019 Active File Status Report

2019 Assessments

- Drain Name
- Summary
- Townships
- Cities & Villages
- State Highways & Railroad
- County at large & County Road Benefit

Certification

ALLEGAN COUNTY DRAIN COMMISSIONER
County Courthouse

Telephone: 269.673.0440

Fax: 269.673.0396

Email: dmedemar@allegancounty.org

The Allegan County Drain Commissioner is charged with diverse responsibilities as regulated by several public acts:

THE DRAIN OFFICE

The Michigan Drain Code (Act 40 of Public Acts of 1956, as amended) is the law that governs the responsibilities of the Drain Commissioner. The Drain Commissioner, Denise Medemar, and staff are responsible for the operation and maintenance of more than 820 established county drains and storm water management systems in Allegan County. This Act requires strict adherence in regard to mailings, meetings, and public notification.

In 2019, 255 drains experienced activity, ranging from establishing new drains to inspections and routine maintenance of existing drains. Of those 255 drains, 117 drainage districts were assessed. The total amount assessed, \$1,697,080.98, was spread to 32 of the 35 Allegan County municipalities, the County at large and for road benefit, the Michigan Department of Transportation for State Highway benefit, and the railway systems that traverse our County.

The Drain Office provides Payoff Requests for Drain Special Assessments for parcel owners and title companies as well as providing assistance throughout the county on drains and flood complaints. Any flooding situations should be immediately reported to the Drain Office at 269-673-0440. Requests for drain maintenance or improvements should also be directed to this number.

DRAIN MAINTENANCE CREW

The Drain Maintenance Crew consists of a Maintenance Supervisor and a Drain Maintenance worker. The Drain Maintenance worker position was vacant from January to June of 2019. Maintenance activities by the maintenance crew include ditch bottom cleaning, tree clearing, debris removal, beaver dam removal, erosion repair, herbicide treatment, and repair of broken pipe on a tile drain. Maintenance is accomplished by using hand tools and small power equipment. In 2019, this form of maintenance was completed on 68 drains.

The Earned Release Program (ERP) and Detail Enabling Better Transition to Society (DEBTS) were initiated by the Sheriff's Department as measures to help address jail overcrowding. In 2019, the Drain Maintenance Crew utilized the DEBTS program and cleaned 17 drains and also provided Storm Inspections. Contractors were hired to clean 51 drains that required larger equipment. Approximately 128 drains in Allegan County and the five

adjacent counties of Barry, Kalamazoo, Kent, Ottawa, and Van Buren were inspected or maintained.

BOARD OF PUBLIC WORKS

The Allegan County Board of Public Works was established and organized under Act 185 of 1957, as amended. In Allegan County the Board of Public Works has seven members that include the Drain Commissioner and six other members appointed by the County Board of Commissioners. The Drain Commissioner is the elected Secretary for the Board of Public Works with Drain Office staff providing administrative support.

The majority of our county's municipal water supply and/or sewage collection and disposal systems were constructed and/or improved using the provisions allowed under Act 185. By utilizing the County's bond rating, a local municipality receives more favorable and affordable financing for these types of public works projects. The County of Allegan/Board of Public Works is the owner of record for the project until the incurred debt is paid in full.

In 2019 there were five active debt service accounts that involved seven municipalities. Debt Service payments are billed to and paid biannually by the affected municipalities. A total of \$991,343.51 in principal, interest, and fees was collected and paid for the year 2019.

INLAND LAKE LEVEL PROJECTS

Part 307 of the Natural Resources and Environmental Protection Act, (Act 451 of 1994), provides for the determination, establishment, and maintenance of the normal height and level of inland lakes in Michigan. Part 307 also requires inspection every three years of all lake level control structures on inland lakes that have normal levels established under this Act. Inspections must be performed by a licensed professional engineer and a copy of the inspection report must be submitted to the Michigan Department of Environment, Great Lakes, and Energy (EGLE).

The County Board of Commissioners delegates administrative duties to the Drain Commissioner to oversee lake level projects and required inspections. Allegan County has seven established lake levels: Base Line Lake, Dumont Lake, Miner Lake, Monterey Lake, Osterhout Lake, Pine Creek Lake, and Pine Lake with Barry County. In 2019, a Dam Safety Inspected was conducted on the Monterey Lake dam.

INLAND LAKE IMPROVEMENT BOARDS

Part 309 of the Natural Resources and Environmental Protection Act, (Act 451 of 1994), provides for the improvement of certain inland lakes; authorizes the dredging and removal of undesirable materials from lakes; authorizes the payment of improvement costs and related expenses through special assessment to properties within an established district; and specifies the county drain commissioner, or his/her designee, to serve as a member of the lake board.

Allegan County has an established lake improvement board for Gun Lake, Hutchins Lake, Lower Scott Lake and Miner Lake. In Allegan County, lake improvement boards have been established primarily for aquatic plant control and abatement of water quality issues.

GENERAL DEVELOPMENTS

There were 20 General Development plans submitted for Storm Water Management Plan review and approval, at the request of various Townships, as follows:

Metallurgical High Vacuum, Clyde Twp	Hawkeye Self Storage, Hamilton
135 th Avenue Storage, Hamilton	Fennville Schools, Fennville
Teddy's Transport, Holland	Great Lakes Heavy Haul, Leighton Twp
Fennville Storage, Fennville	Hamilton Steel Fabrications, Hamilton
Nifty Pine Drive, Salem Twp	Diamond Springs Steel, Overisel Twp
Fennville District Library, Fennville	Cultivate Church, Hamilton
1215 142 nd Ave LLC, Dorr Twp	Burgess Concrete, Dorr Twp
Dorr Veterinary Clinic, Dorr Twp	Fields Campground, Casco Twp
TMS Storage, Dorr Twp	South Holland Rentals, Holland
Trillium Woods, Dorr Twp	Lot 6 Moline Industrial Park, Leighton Twp

MOBILE HOME PARKS

Public Act 419 of 1976, the Mobile Home Commission Act, requires that a person who desires to develop a mobile home park shall submit a preliminary plan to the appropriate municipality, local health department, county road commission, and county drain commissioner for preliminary approval. The Drain Commissioner shall review and may approve outlet drainage to ensure that development of the proposed mobile home park does not cause flooding offsite. In 2019, The Drain Commissioner received one submission for review and approval for Hidden Creek Community Phase 3 in Fillmore Township and Sunrise Condominiums in Fillmore Township.

SITE CONDOMINIUMS

Act 59 of 1978, the Condominium Act, requires that written notice of intent to construct a condominium project be provided to the appropriate city, village, township, or county, the County Road Commission and the County Drain Commissioner. The Drain Commissioner received three storm water management reviews for 2019:

3620 30th Street, Salem Twp
West Wind Village Phase 2, Laketown Twp
Cottages of Kelly Creek Condominiums, Laketown Twp

SUBDIVISION DEVELOPMENT

Public Act 288 of 1967, as amended, the Land Division Act, provides the main regulatory mechanism to ensure that subdivisions meet the standards set by local governmental officials.

The role of the Drain Commissioner under this Act is to ensure that adequate storm water facilities are designed, constructed, and maintained to ensure that landowners within the subdivision are protected from flooding and that the development does not cause an increase in flooding outside of the subdivision.

The Drain Commissioner requires that the plat proprietor/developer provide for adequate storm water facilities. Section 433 of the Michigan Drain Code provides for the construction of a drainage system by the developer to serve a newly established plat and the subsequent establishment of a drainage district in relation to the storm water facility. The drainage system is constructed according to specifications and standards set by the Drain Commissioner. Upon completion, the system can then be remanded to the Drain Commissioner as an established county drain using a formal document known as a 433 Agreement. In 2019, no plat developments were submitted.

MS4 PERMIT

In 2016, the Allegan County Drain Commissioner was required to apply for an NPDES Jurisdictional Permit for storm water discharges from a regulated municipal separate storm sewer system (MS4). This permit required the creation of a Storm Water Management Plan composed of six major sections: Public Education Program, Public Involvement and Participation, Illicit Discharge Elimination Program, Post Construction Storm Water Management Program, Construction Storm Water Runoff Control, and Pollution Prevention/Good Housekeeping Standards.

From 2017 to 2019 the Allegan County Drain Commissioner's Office worked with the Macatawa Area Coordinating Council, in coordination with other County Departments, to review and update plan components per MDEQ's initial comments. In 2019, the MS4 permit was submitted to EGLE. As of the end of 2019, the permit had not been issued.

SAW GRANT

In December 2017, the Drain Office received notification that the SAW Grant offered through the Michigan Department of Environmental Quality, which we initially submitted in 2013 with Board of Commissioner approval on Thursday, November 14, 2013, was approved. The amount is \$120,000 which the grant will reimburse ninety percent (\$108,000) with a ten percent local match (\$12,000) which has an end date of December 1, 2020. The original application provided funding to clean and televise six drains, provide GIS hardware/software training, and records scanning.

2019 Activity Listing

Drain No.	Drain Name	Problem reported	Application/Petition Re	Application/Petition Re	Board of Determinatio	Engineering	Bids/Proposals requ	Petition Construction	Inspection Routine 3	433 Agreement Inspe	Inspection Complec	Mechanical Cleanin	Hand Cleaning-Drain	Letter to Traversed O	Culverts Repaired/Re	Assess 2018	Assess 2019	Additional Detail/Information
001	Abbott																	
002	Adams & Branch																	
003	Agan & Branch																	
747	Airport Park Plat																	
004	Alberts & Winters																	
005	Albright																	
717	Amity Lanes																	
011	Andrews																	
746	Arndt Plat (433 agree)																	
014	Ash																	
015	Aull																	
016	Austin & Branch																	
071	B. Smit																	
017	Bailey-Bodfish & Branches																	
018	Baird																	
618	Baker																	
019	Barnum & Anderson																	
020	Barr																	
690	Base Line Lake IC																	
021	Baseline IC																	
022	Baseline Lake																	
023	Baseline Lake Control																	
025	Bates																	
027	Baughman																	
029	Bear Swamp & Ext.																	
030	Beaver & Branches																	
031	Beaver Dam																	
032	Belden																	
033	Belka																	
034	Bellingham																	
035	Bennet																	
036	Bensley																	
040	Bensley #1																	
038	Berens																	
834	Big Lake Drain																	
041	Bisbee IC																	
042	Bixler																	
043	Black Creek IC																	
045	Blackman																	
046	Black River																	
047	Blain																	
048	Blain # 1																	
049	Blain # 2																	
769	Blue Ridge Acres (433 agree)																	
051	Boerman																	
052	Boggs & Almack																	
661	Boot Lake																	
053	Boss																	
741	Boyd IC																	
662	Boyles																	
055	Boysen																	
056	Bradock																	
057	Brainard & Pease Branch																	
059	Brandt IC																	
060	Brennen																	
061	Bridge Acres																	
064	Brouwer																	
065	Brown																	
066	Brown																	
067	Brown																	
068	Brown & Staley																	
070	Brush Creek IC																	
072	Buck																	
074	Buck Hole																	
075	Buck Lake																	
664	Bucknell																	
077	Burch & Phillips																	
076	Burchardt																	
078	Burkhead & Branch																	
676	Bush Creek																	
080	Buskirk, Ext. & Branch																	
082	Butternut Creek																	
083	Button																	
085	Byron Dorr IC																	
086	Cackler																	
087	Cady																	
138	Camelot Woods (433 agree)																	
090	Carlson																	
091	Carpenter Intercounty																	
092	Carter																	
093	Carver																	
821	Casco																	

2019 Activity Listing

Drain No.	Drain Name	Problem reported	Application/Petition Rec	Application/Petition Ref	Board of Determination	Engineering	Bids/Proposals req	Petition Construction	Inspection Routine 3	433 Agreement Inspe	Inspection Completed	Mechanical Cleaning	Hand Cleaning-Drain	Letter to Traversed O	Culverts Repaired/Re	Assess 2018	Assess 2019	Additional Detail/Information
637	Casey & Closs																	
094	Cedar Creek																	
095	Chart IC																	
096	Cheshire No. 3																	
098	Cheshire No. 6																	
099	Cheshire No. 7																	
101	Cheshire No. 9																	
102	Cheshire No. 10																	
103	Cheshire No. 11																	
104	Cheshire No. 12																	
106	Cheshire No. 15																	
108	Cheshire No. 17 & Ext.																	
109	Cheshire No. 19																	
110	Cheshire No. 20																	
111	Cheshire No. 21 & Gillespie Ext.																	
112	Cheshire No. 22																	
113	Cheshire No. 23																	
117	Chestog																	
118	Clair																	
623	Clark & Phillips																	
781	Clearbrook Estates - (433 agree't)																	
120	Clock																	
123	Coffey																	
124	Colburn																	
126	Conkle																	
127	Cooch																	
128	Cook & Chappell																	
624	Cook & Johnson																	
766	Cooke Farms- (433 agree't)																	
088	Coppock																	
129	Cooley																	
665	Corning																	
711	Cottage Owners																	
130	Cranberry Lake IC																	
131	Crane																	
133	Crow & Black & Extension																	
134	Cuddy IC																	
135	Culver																	
136	Curtis & Extension																	
137	Dailey																	
139	Dalrymple																	
140	Damouth																	
141	Darga																	
142	Darling																	
143	Deal IC																	
144	Dean																	
145	Dean																	
764	Deerfield Run																	
147	DenBleyker																	
148	Deneffs																	
608	Deverwater																	
151	Dickinson Chambers & Shaffer																	
152	Dilley																	
149	Divine																	
155	Dokey																	
156	Doiegowski																	
767	Dorr Commerce																	
708	Dorr Meadows - (433 agree't)																	
800	Dorr Ranch - (433 agree't)																	
157	Dorr Village																	
159	Doster																	
744	Downda - (433 agree't)																	
160	Drain #47 IC																	
161	Dreher & Extension																	
162	Drum																	
163	Drury																	
165	Dumont Lake																	
825	Dumont Lake Level Control																	
166	Duncan Lake IC																	
168	East Fillmore																	
686	East Lake																	
169	Eaton																	
171	Edgerton																	
172	Edwards																	
174	Elm Creek																	
175	Emerson Lake																	
176	Engle																	
177	Enos																	
178	Eskes																	
179	Falconer																	
180	Fales																	
181	Farm & Resort																	

2019 Activity Listing

Drain No.	Drain Name	Problem reported	Application/Petition Rec	Application/Petition Rec	Board of Determinatic	Engineering	Bids/Proposals requ	Petition Construction	Inspection Routine 3	433 Agreement Inspe	Inspection Complet	Mechanical Cleaning	Hand Cleaning-Drain	Letter to Traversed O	Culverts Repaired/Re	Assess 2018	Assess 2019	Additional Detail/Information
182	Felts & Ext.																	
183	Fenner Lake																	
185	Fennville & Billings																	
692	Fillmore No.2																	
187	Fillmore No.8																	
189	Fillmore No.12																	
190	Fillmore No.14																	
693	Fillmore No.15																	
614	Fillmore No. 17																	
694	Fillmore No.19																	
560	Finch																	
192	Fisher																	
195	Fiesser & Synder																	
164	Flora																	
196	Flora No.2 & Ext																	
197	Flynn																	
173	Fox																	
198	Fox																	
199	Fox Lake																	
200	French																	
201	Frey																	
202	Fry																	
698	Fry																	
727	Galaxy Estates # 2 - (433 agree't)																	
666	Garwell																	
724	Ganges																	
710	Garden View & Secluded Acres																	
205	Gardiner																	
206	Gardner																	
786	Gaslight Estates - (433 agree't)																	
209	Gere																	
210	Geib, Branch & Ext.																	
211	Germain																	
213	Gibson																	
214	Gilbert & Wademan																	
216	Gilger																	
215	Gillespie																	
639	Gillett																	
734	Glenn Shores																	
756	Glenn View - (433 agree't)																	
218	Gley																	
219	Godfrey																	
221	Goldspring																	
220	Golf																	
224	Graham																	
229	Green																	
753	Green Lake Ridge Estates- (433 agree't)																	
770	Green Lake Ridge 2 - (433 agree't)																	
779	Green Lake Ridge 3 & 4 - (433 agree't)																	
718	Greenfield Estate - (433 agree't)																	
232	Greggs Brook																	
752	Gudith																	
233	Gulch																	
790	Gun Lake Cove																	
234	Gun River IC																	
237	Hadaway																	
238	Hale																	
240	Hamilton																	
241	Haney																	
678	Harmon IC																	
640	Harper																	
607	Harrington																	
636	Harrington																	
641	Harrington																	
245	Hartley																	
246	Hartsuiker																	
782	Harvest Meadows - (433 agree't)																	
677	Hastings																	
248	Hayes																	
249	Hayward																	
250	Hazen																	
251	Heath																	
252	Heck																	
253	Heibel																	
254	Helbach & Berthwick																	
255	Helmer																	
761	Heritage Meadows																	
789	Heritage Pines- (433 agree't)																	
257	Herlon																	
258	Herp																	
260	Herring																	
667	Hersey																	

2019 Activity Listing

Drain No.	Drain Name	Problem reported	Application/Petition Re	Application/Petition Re	Board of Determinati	Engineering	Bids/Proposals reque	Petition Construction	Inspection Routine 3	433 Agreement Inspe	Inspection Completed	Mechanical Cleaning	Hand Cleaning-Drain	Letter to Traversed O	Culverts Repaired/Re	Assess 2018	Assess 2019	Additional Detail/Information
261	Hewitt																	
262	Heyward																	
642	Hicks																	
705	Hidden Forest (433 Agree't)	■				■	■		■					■				
733	Hidden Forest No. 4					■												
836	Hidden Lake (proposed)		■															
264	Hill Lake																	
265	Hillards																	
266	Hillman																	
643	Hodge No.9																	
268	Hodgeman																	
269	Hoffman,Harrington, Truax																	
270	Hoke																	
271	Holbrook & Branch																■	
272	Holland																	
273	Holt					■												
274	Holton																	
277	Hoover																	
278	Hopkins Station																■	
279	Hoyt & Branch																	
280	Hubbard IC																■	
282	Hudson & Branch																■	
284	Hutcheson																	
644	Hyde																	
700	Iciek																	
285	Iciek, Ehle & Ext.																	
286	Indian Lake																	
683	Jack Pine Ridge - (433 agree't)																	
668	Jackson					■											■	
287	Jacobs																	
288	Jager Crane					■											■	
289	Jan Belt																	
291	Johnson					■											■	
292	Jones																	
628	Jones																■	
820	Kay Drive					■											■	
293	Kaylor & Branch																	
294	Keel & Branch																	
295	Kelly																	
296	Kelly Lake IC					■											■	
788	Kensington Place - (433 agree't)																	
297	Kern																	
298	Kerr																	
300	Kettleman No.2																	
301	Kleibusch																■	
302	Kleinheksel-Raven	■					■				■			■				
303	Klopfenstein IC																	
304	Knickelbine																	
305	Knoll IC																	
306	Knuth																	
307	Kooiker																	
308	Kooyers																	
309	Krug & Extension	■				■					■			■			■	
310	Krumbach																	
311	Kuipers	■				■					■			■			■	
702	Lakeshore #1																	
704	Lakeshore #2																■	
715	Laketown Village					■											■	
765	Lamar Park - 433 agree't																	
313	Lane & Griffin IC	■					■				■			■				
315	Lawrence																	
319	Laws																	
317	Layton																	
318	Lee																■	
319	Leggett and Sargent					■											■	
320	Leighton																■	
321	Leighton & Dorr																■	
322	Leighton No. 1	■				■			■		■			■			■	
716	Leighton Industrial Park - (433 agree't)																	
768	Leighton Industrial Park No.2																	
324	Lenhart																	
325	Lenters																	
631	Lester																	
327	Leverich																■	
670	Lincoln																	
328	Lindsley																	
638	Lindsley & Hubbard																	
331	LL, Lance																	
801	Lone Oak - (433 agree't)																	
333	Loomis																	
332	Loveridge																■	
334	Lower #4 Branch & Extension																	

2019 Activity Listing

Drain No.	Drain Name	Problem reported	Application/Petition Rejected	Application/Petition Rejected	Board of Determination	Engineering	Bids/Proposals required	Petition Construction	Inspection Routine 3	433 Agreement Inspection	Inspection Completed	Mechanical Cleaning	Hand Cleaning-Drain	Letter to Traversed Owners	Culverts Repaired/Replaced	Assess 2018	Assess 2019	Additional Detail/Information
335	Lowther																	
336	Lubbers																	
337	Luce or Cheshire #24																	
338	Lugtigheid																	
369	Lulu																	
341	Lyle																	
342	Lynch																	
343	McCann																	
344	McConnell	■					■				■			■				
345	McConnell					■												
347	McHenry-Decker																	
349	McIntyre Lake																	
348	McIntosh IC															■		
351	McVean																	
352	Maatman-Jaarda					■										■	■	
353	Mankins																	
354	Mann Creek																	
357	Manor																	
755	Maple Gate - (433 agree't)																	
356	Maplewood IC																	
358	Marble																	
359	Marron																	
360	Martin																	
361	Martin																	
362	Martin-Watson	■					■		■		■			■				
364	May																	
363	Maxwell					■											■	
365	Mead																	
366	Mechem																	
645	Merchant																	
367	Miami Park					■												■
368	Miller																■	
671	Miller																	
370	Miller Lake																	
371	Miller-McKeown					■											■	
632	Miller - Rodgers																	
372	Miner Lake										■			■				
373	Miner Lake Level Control					■											■	
374	Mineral Springs & Hilbert					■												
376	Minkler Lake																	
377	Moline & Branch	■					■				■			■			■	
751	Moline Industrial Park (433 agree't)																	
379	Monteith, Branch & Extension																	
378	Monterey & Heath																	
682	Monterey Lake Level						■											
382	Morris																	
383	Morse																	
385	Mottor																	
387	Murdock																	
388	Murphy					■											■	
389	Murray Lake IC																	
390	Myers																	
391	Myers & Patterson					■												
805	Nature View Estates																■	
811	Neerken's Plat		■				■											
758	Nelson Court (433 agreement)																	
392	Nelson - Gilkey	■					■		■		■			■				
393	Newcombe																	
394	Neuman																	
395	Nichols					■												
619	Nolan																	
396	Norris																	
397	North & South Twin																■	
739	North Base - (433 agree't)																	
701	North Shore					■											■	
398	North State Rd & Spaulding					■											■	
399	North Town Line																	
400	Nyberg					■											■	
778	Oak View Farms (433 agree't)																	
797	Oakland Hills (433 agree't)																	
401	Ockford	■				■			■		■			■			■	
773	Orlo-Lyn Acres (433 agreement)																	
405	Orr																	
406	Osgood Lake																	
407	Osman																	
408	Osterhout Lake Control																■	
409	Otsego & Alamo IC																	
685	Ottohan IC					■												
410	Overhiser-Spencer	■					■		■		■			■				
411	Overisel Village																	
412	Oxley																■	
742	Paradise Woods - (433 agree't)					■			■		■			■			■	

2019 Activity Listing

Drain No.	Drain Name	Problem reported	Application/Petition Rec	Application/Petition Re	Board of Determinatio	Engineering	Bids/Proposals requ	Petition Construction	Inspection Routine 3	433 Agreement Inspe	Inspection Complete	Mechanical Cleaning	Hand Cleaning-Drain	Letter to Traversed O	Culverts Repaired/Re	Assess 2018	Assess 2019	Additional Detail/Information
818	Paris Ridge Estates - (433 agree't)																	
414	Park & Laketown IC																	
672	Parker																	
415	Parker & Branch IC																	
416	Parmelee																	
417	Parrish																	
418	Patterson																	
657	Patterson																	
419	Paul																	
420	Paul																	
421	Payne																	
422	Pearson																	
737	Pearl Street																	
424	Perry																	
425	Peters																	
426	Peterson																	
427	Phillips & Ext																	
745	Pheasant Ridge Estates																	
428	Pickereel Lake																	
430	Pickett																	
429	Pickle																	
431	Pierce & Extension																	
726	Pine Acres - (433 agree't)																	
432	Pine Creek Lake Level																	
706	Pine Drive																	
730	Pine Drive No. 2																	
703	Pine Hills																	
433	Pine Lake Level																	
434	Piper & Robinson																	
435	Ply																	
413	Pogue																	
436	Poll																	
437	Pope and Yeldon																	
729	Potawatomi Pines - (433 agree't)																	
438	Potts & Wagner																	
439	Powers																	
440	Pratt																	
754	Prins Acres - (433 agree't)																	
646	Pritchard																	
658	Pullen																	
442	Pullman & Arnold																	
443	Pullman & Branch																	
403	Quarter Line & Eighth Line																	
444	Raab																	
680	Rabbit River																	
796	Rabbit River Farms - (433 agree't)																	
819	Recreation																	
447	Red Run																	
709	Red Run Estates (433 agree't)																	
446	Reeves																	
802	Reno Drive (433 agree't)																	
448	Reno IC																	
449	Rheinhart																	
450	Rice																	
451	Richmond																	
452	Ridgley																	
453	Ring & Perkins																	
603	Rittenhaus																	
454	Ritz																	
757	Riverbend Estates No 4 - (433 agree't)																	
795	Riverledge - (433 agree't)																	
673	Robins																	
648	Rockwell & Mosher																	
456	Rodgers IC																	Intercounty Drain
731	Rookus Estates - (433 agree't)																	
457	Root																	
459	Rose																	
460	Rose Marsh																	
461	Rotman																	
462	Rowe																	
687	Rowe																	
464	Rozema																	
466	Ruppel																	
467	Sackett																	
469	Saddle Lake Extension IC																	
470	Saddler IC																	
471	Sager Lake																	
473	Sal & Extension																	
472	Salem-Monterey																	
609	Salter																	
760	Sambroek Woods - (433 agree't)																	
807	Sandy Beach IC																	

2019 Activity Listing

Drain No.	Drain Name	Problem reported	Application/Petition Rec	Application/Petition Ref	Board of Determinatic	Engineering	Bids/Proposals reqeue	Petition Construction	Inspection Routine 3	433 Agreement Inspe	Inspection Completec	Mechanical Cleaning	Hand Cleaning-Drain	Letter to Traversed O	Culverts Repaired/Re	Assess 2018	Assess 2019	Additional Detail/Information
763	Sandy Hills - (433 agree't)																	
475	Sargent																	
612	Sawald																	
476	Schaap IC																	
477	Scheiern & Extension																	
774	Schermerhorn Lake (433 agree't)																	
478	Schipper																	
480	Schnieder IC																	
481	Schultz																	
482	Schumaker																	
533	Schwartz																	
649	Scott																	
483	Scott																	
485	Scott & Whitcomb																	
484	Scott Creek & Branch																	
780	Secluded Acres																	
710	Secluded Pines Estate																	
720	Secluded Pines Estate No 2																	
369	Section 20 Interceptor																	
486	Section 10																	
488	Section 34																	
489	Section Line																	
490	Section Line																	
492	Selkirk-Sprague																	
816	Selkirk Lake																	
776	Serenity Pines (433 agree't)																	
794	Serenity Ridge (433 agree't)																	
493	Sessions																	
494	Setter																	
495	Severens																	
496	Shad Lake																	
659	Shea																	
650	Sheffer																	
679	Shelbyville																	
785	Signal Point (433 agreement)																	
498	Silcox																	
792	Silver Diamond Acres																	
499	Silver Lake																	
500	Sink																	
501	Sinkhole																	
502	Sisson & Branch																	
503	Slater No. 17 & Ext.																	
504	Slocum																	
506	Smith																	
507	Smith																	
634	Smith & Corning																	
508	Snider																	
510	Sommers																	
512	South & Extension																	
688	South Branch # 5																	
513	South Center Line																	
514	South State Road & Clyde																	
809	Southpointe Trails (433 agreement)																	
515	Spencer-Otis-Dennis																	
652	Sperry																	
516	Spotts																	
521	Spreitzer																	
519	Spring Brook																	
520	Spring Run & Extension																	
524	Steffens																	
525	Steinke																	
526	Sterling																	
527	Sterling																	
528	Stone																	
530	Sturm																	
531	Sulaski																	
719	Summer Creek Estates #2 (433 agree't)																	
722	Sunny View Estates (433 agree't)																	
732	Sunny View Estates #2 (433 agree't)																	
798	Sunquest Acres (433 agree't)																	
759	Sunset Shores																	
713	Superior Plat (433 agree't)																	
728	Superior Plat #2 (433 agree't)																	
532	Sutherland																	
535	Symons																	
712	Tanglewood (433 agree't)																	
537	Tanis																	
536	Tanner																	
538	Taylor																	
539	Taylor																	
541	Terrill																	
791	Terravita Site Condo																	

2019 Activity Listing

Drain No.	Drain Name	Problem reported	Application/Petition Re	Application/Petition Rea	Board of Determinatic	Engineering	Bids/Proposals requ	Petition Construcion	Inspection Routine 3	433 Agreement Inspe	Inspection Completec	Mechanical Cleaning	Hand Cleaning-Drain	Letter to Traversed O	Culverts Repaired/Re	Assess 2018	Assess 2019	Additional Detail/Information
743	The Reserve - (433 agree't)																	
542	Thieves Den																	
543	Thomas IC																	
545	Thompson																	
546	Thompson																	
547	Tibbe																	
549	Tiffany																	
660	Tiger																	
808	Timber Ridge Bay - (433 agree't)																	
551	Tobey																	
552	Tobin																	
553	Tollenaar																	
554	Top																	
772	Tornopilsky																	
654	Towner																	
555	Townline																	
557	Towsley																	
559	Trowbridge-Cheshire																	
186	Tulip IC																	
563	Upper #4																	
564	Utter																	
565	Van Den Beldt																	
566	Vander Bie																	
613	Varney																	
567	Veen																	
568	Veldhoff																	
569	Vida																	
570	Virginia Park IC																	
571	Voss																	
572	Wadsworth																	
573	Wadsworth Canal & Birkholz																	
575	Waldron																	
817	Walker																	
577	Ward & Ext.																	
580	Warner																	
581	Warnock & Ext																	
582	Watson Truck Line																	
721	Wayland Meadows																	
583	Weber																	
584	Weeks																	
585	Weick																	
590	Weist																	
586	Welch																	
587	Welfare																	
588	Welsh & Wait																	
787	West Shore Woods (433 agreement)																	
833	West Wind Village																	
591	Wilcox																	
777	Wild Flower Ridge																	
725	Wilkie																	
697	Wilkinson																	
593	Wilks																	
594	Williams																	
699	Wiley																	
595	Willow																	
596	Wilson IC																	Intercounty Drain
597	Wilson																	
814	Wind & Woods Petition																	
598	Winks & Branch																	
600	Wolf																	
601	Wolf - Levett - Bauer																	
762	Wolf - Plat																	
793	Woodridge Estates (433 agreement)																	
602	Wright																	
604	Wyman																	
655	Youngs																	

2019 ASSESSMENTS

Drain #	Drain Name	Township, City, Village	Year of Year		
717.001	Amity Lane	City of Village of Douglas	1 of 1	\$	5,000.00
746.001	Arndt Plat	Dorr	1 of 1	\$	3,100.00
015.001	Aull	Clyde, Fennville City	9 of 10	\$	7,614.93
016.001	Austin & Branch	Cheshire, Trowbridge	1 of 2	\$	6,000.06
017.001	Bailey-Bodfish & Branches	Casco	1 of 1	\$	9,651.73
021.001	Baseline Intercounty	Otsego, Trowbridge - VAN BUREN	1 of 2	\$	6,862.55
022.001	Baseline Lake	Trowbridge	1 of 1	\$	3,900.00
690.001	Base Line Lake Intercounty	Lee - VAN BUREN	1 of 2	\$	1,385.83
031.001	Beaver Dam	Ganges	1 of 1	\$	6,000.00
038.001	Berens	Salem	1 of 1	\$	3,300.00
057.001	Brainard & Pease	Otsego	2 of 3	\$	8,326.14
060.001	Brennen	Cheshire	1 of 3	\$	5,750.00
067.001	Brown	Hopkins, Watson, Hopkins Village	1 of 1	\$	3,300.00
070.001	Brush Creek Intercounty	Cheshire, Lee - VAN BUREN	1 of 1	\$	17,000.00
077.001	Burch & Phillips	Lee	2 of 2	\$	15,486.71
077.002	Burch & Phillips	Lee	1 of 1	\$	1,183.50
078.001	Burkhead & Branch	Cheshire, Lee	2 of 2	\$	16,320.81
085.001	Byron-Dorr Intercounty	Dorr, Leighton, Salem - KENT	1 of 1	\$	35,600.00
087.900	Cady	Casco	1 of 1	\$	1,000.00
090.001	Carlson	Watson	1 of 1	\$	5,000.00
093.001	Carver	Laketown	1 of 1	\$	3,099.99
637.900	Casey & Closs	Otsego	1 of 1	\$	980.08
111.001	Cheshire 21 & Gillespie	Cheshire, Trowbridge	1 of 1	\$	13,900.00
113.001	Cheshire #23	Cheshire	1 of 1	\$	8,350.00
118.001	Clair	Trowbridge	2 of 2	\$	7,997.64
123.001	Coffey	Monterey, Overisel, Salem	7 of 10	\$	39,949.32
134.001	Cuddy Intercounty	Wayland - BARRY	4 of 15	\$	39,070.82
135.001	Culver	Martin, Martin Village	1 of 1	\$	7,600.00
137.900	Dailey	Casco, Lee	1 of 1	\$	1,000.00
139.001	Dalrymple	Casco, Lee	3 of 3	\$	2,659.25
155.001	Dokey	Lee	1 of 2	\$	6,350.07
767.001	Dorr Commerce	Dorr	1 of 1	\$	4,900.00
708.001	Dorr Meadows	Dorr	2 of 2	\$	2,028.87
825.001	Dumont Lake Level Control	Allegan, Monterey	3 of 10	\$	11,753.49
168.001	East Fillmore	Fillmore, Overisel	1 of 1	\$	48,500.00
174.001	Elm Creek	Casco, Clyde, Ganges, Lee	1 of 2	\$	24,950.30

2019 ASSESSMENTS

Drain #	Drain Name	Township, City, Village	Year of Year		
178.001	Eskes & Ext.	Fillmore, Overisel	1 of 1	\$	7,700.00
182.001	Felts	Monterey, Salem	1 of 1	\$	9,130.00
185.001	Fennville-Billings	Clyde, Manlius, Fennville	1 of 1	\$	19,581.00
187.001	Fillmore #8	Fillmore, Holland City	1 of 1	\$	5,790.00
195.001	Flesher & Snyder	Salem	2 of 3	\$	6,302.95
196.001	Flora No. 2	Casco, Lee	5 of 10	\$	24,019.56
198.001	Fox	Otsego, Trowbridge, Watson	1 of 1	\$	3,275.00
210.001	Geib	Overisel, Salem	1 of 1	\$	14,460.00
214.001	Gilbert-Wademan	Leighton	7 of 10	\$	20,705.57
756.001	Glenn View	Fennville	1 of 1	\$	4,900.00
220.001	Golf	Laketown, Saugatuck, Saugatuck City	7 of 10	\$	19,917.09
232.001	Greggs Brook	Martin, Wayland	1 of 1	\$	6,300.00
234.001	Gun River Intercounty	GunPlain/Martin/Otsego/Watson/Wayland/Martin Village/Otsego&Plainwell-BARRY	1 of 1	\$	65,020.90
245.001	Hartley	Cheshire	2 of 2	\$	2,361.53
761.001	Heritage Meadows	Laketown	1 of 1	\$	4,670.00
271.001	Holbrook & Branch	Wayland	2 of 2	\$	4,671.10
278.001.1	Hopkins Station	Hopkins, Monterey, Hopkins Village	5 of 10	\$	16,541.39
280.001	Hubbard Intercounty	Otsego - KALAMAZOO	2 of 2	\$	7,946.86
668.001	Jackson	Wayland	1 of 1	\$	7,020.00
288.001	Jager Crane	Saugatuck, City of Douglas	5 of 10	\$	30,189.54
291.001	Johnson	Leighton	1 of 1	\$	13,680.00
628.001	Jones	Dorr, Leighton	1 of 1	\$	3,300.00
820.001	Kay Drive	Dorr	3 of 10	\$	26,802.12
296.903	Kelly Lake Intercounty	Laketown - OTTAWA	5 of 15	\$	53,325.18
309.001	Krug	Hopkins, Monterey, Hopkins Village	1 of 1	\$	3,850.00
311.001	Kuipers & Branch	Fillmore, Laketown	1 of 1	\$	6,490.00
715.001	Laketown Village	Laketown	1 of 1	\$	5,000.00
318.001	Lee	Lee	5 of 10	\$	34,703.07
320.001	Leighton	Otsego	2 of 2	\$	3,895.97
322.001	Leighton #1	Leighton	1 of 1	\$	3,848.00
352.001	Maatman-Jaarda	Fillmore, Manlius, Holland City	3 of 5	\$	72,676.05
363.900	Maxwell	Cheshire	1 of 1	\$	1,000.00
367.001	Miami Park	Casco	1 of 1	\$	8,800.00
371.001	Miller-McKeown	Ganges	2 of 2	\$	6,545.87
373.002	Miner Lake Level Control	Allegan	3 of 10	\$	40,170.51
377.001	Moline	Dorr, Leighton	8 of 10	\$	50,103.79

2019 ASSESSMENTS

Drain #	Drain Name	Township, City, Village	Year of Year	\$	
701.001	North Shore	Casco	4 of 20	\$	70,098.48
398.001	North State Road/Spaulding	Cheshire, Clyde, Ganges, Lee, Valley	1 of 1	\$	8,715.00
400.001	Nyberg	Gun Plain	1 of 1	\$	17,140.00
797.001	Oakland Hills	Salem	1 of 1	\$	5,500.00
401.001	Ockford	Casco, Clyde, Ganges, Lee	1 of 1	\$	8,740.00
412.001	Oxley	Casco, Lee	3 of 3	\$	3,467.45
742.001	Paradise Woods Estates	Fennville	1 of 1	\$	3,170.00
426.001	Peterson	Clyde, Lee	2 of 2	\$	8,029.62
431.900	Pierce & Ext.	Hopkins, Wayland	1 of 1	\$	3,780.00
754.001	Prins Acres	Laketown	1 of 1	\$	5,860.00
819.001	Recreation	Ganges	3 of 7	\$	19,185.52
453.001	Ring & Perkins	Hopkins	3 of 7	\$	6,368.95
757.001	Riverbend	Allegan	1 of 1	\$	2,940.00
461.001	Rotman	Fillmore, Holland City	1 of 1	\$	10,825.00
609.900	Salter	Cheshire	1 of 1	\$	906.21
807.001	Sandy Beach Intercounty	Wayland - BARRY	9 of 10	\$	4,274.18
763.001	Sandy Hills	Dorr	1 of 1	\$	3,800.00
481.001	Schultz	Cheshire, Valley	1 of 1	\$	5,325.00
482.001	Schumaker	Salem	4 of 10	\$	55,480.50
483.001	Scott	Casco, Ganges	3 of 3	\$	2,916.22
484.200	Scott Creek	Lee	8 of 10	\$	28,585.29
369.001	Section 20 Interceptor	Saugatuck	1 of 1	\$	6,780.00
492.001	Selkirk & Sprague	Hopkins, Wayland, Wayland City	1 of 1	\$	14,420.00
816.001	Selkirk Lake	Martin, Wayland	3 of 20	\$	95,361.99
785.001	Signal Point	Allegan	1 of 1	\$	3,050.00
500.001	Sink	Dorr	1 of 1	\$	6,410.00
503.001	Slater #17	Otsego, Trowbridge	1 of 1	\$	7,350.00
688.001	South Branch #5	Fillmore, Manlius, Overisel, Holland City	1 of 1	\$	20,880.00
515.001	Spencer Otis Dennis	Casco	2 of 2	\$	4,947.85
525.001	Steinke	Dorr	1 of 1	\$	5,380.00
719.001	Summer Creek Est No. 2	Salem	2 of 2	\$	1,355.77
798.001	SunQuest Acres	Dorr	1 of 1	\$	7,270.00
712.001	Tanglewood	Laketown	1 of 1	\$	5,200.01
537.001	Tanis	Overisel	1 of 1	\$	3,650.00
536.001	Tanner	Dorr	2 of 3	\$	3,566.67
538.001	Taylor	Cheshire	3 of 3	\$	4,928.47

2019 ASSESSMENTS

Drain #	Drain Name	Township, City, Village	Year of Year		
552.001	Tobin	Allegan	3 of 3	\$	11,413.85
553.001	Tollenaar	Leighton	1 of 1	\$	19,700.00
554.001	Top	Overisel	1 of 1	\$	13,400.00
570.001	Virginia Park Intercounty- Main	Laketown - OTTAWA	8 of 10	\$	20,230.29
570.200	Virginia Park Intercounty- Pine Hollow	Laketown - OTTAWA	8 of 10	\$	7,980.81
572.001	Wadsworth	Ganges, Saugatuck	1 of 1	\$	3,600.00
575.001	Waldron	Otsego, Trowbridge	1 of 1	\$	3,450.00
817.001	Walker	Ganges	5 of 10	\$	23,752.55
577.001	Ward Extension & Branch	Trowbridge	7 of 10	\$	17,194.63
581.001	Warnock & Ext.	Saugatuck, Douglas City, Saugatuck City	4 of 10	\$	94,648.79
590.001-2	Weist	Dorr, Salem	8 of 10	\$	16,486.74
TOTAL				\$	1,697,080.98

2019 ASSESSMENTS

SUMMARY

Townships at Large: (for Public Health Benefit)	\$ 339,850.61
Townships on Description: (for Benefit to Lands)	\$ 1,136,045.00
Cities at Large: (for Public Health Benefit)	\$ 43,974.52
Cities on Description: (for Benefit to Lands)	\$ 93,431.56
Villages at Large: (for Public Health Benefit)	\$ 4,136.67
Villages on Description: (for Benefit to Lands)	\$ 13,879.15
State Highways at Large: (for Benefit)	\$ 3,789.82
Railroads at Large: (for Benefit)	\$ 8,194.50
Allegan County at Large (for Benefit)	\$ 33,414.66
Allegan County Roads at Large (for Benefit)	\$ 20,364.49
TOTAL ASSESSMENT FOR 2019:	\$ 1,697,080.98

2019 ASSESSMENTS

TOWNSHIPS					
Township	Number	Drain Name	Year of Year	Amount at Large	Amount on Description
ALLEGAN	01				
	825.001	Dumont Lake Level Control	3 of 10	973.19	3,668.32
	373.002	Miner Lake Level Control	3 of 10	0.00	40,170.51
	757.001	Riverbend	1 of 1	411.60	1,931.88
	785.001	Signal Point	1 of 1	366.00	2,124.26
	552.001	Tobin	3 of 3	1,747.16	9,287.65
		ALLEGAN TOTAL		\$3,497.95	\$57,182.62
CASCO	02				
	017.001	Bailey-Bodfish & Branches	1 of 1	1,158.21	8,081.20
	087.900	Cady	1 of 1	1,000.00	0.00
	137.900	Dailey	1 of 1	500.00	0.00
	139.001	Dalrymple	3 of 3	319.11	2,081.98
	174.001	Elm Creek	1 of 2	2,994.00	13,303.38
	196.001	Flora No 2	5 of 10	3,642.27	3,473.35
	367.001	Miami Park	1 of 1	1,144.00	6,052.46
	701.001	North Shore	4 of 20	20,120.28	49,978.20
	401.001	Ockford	1 of 1	1,048.80	4,799.96
	412.001	Oxley	3 of 3	520.12	1,287.14
	483.001	Scott	3 of 3	0.00	34.38
	515.001	Spencer Otis Dennis	2 of 2	607.10	4,155.29
		CASCO TOTAL		\$33,053.89	\$93,247.34
CHESHIRE	03				
	016.001	Austin & Branch	1 of 2	840.00	60.00
	060.001	Brennen	1 of 3	1,150.00	3,737.50
	070.001	Brush Creek Intercounty	1 of 1	1,700.00	4,217.45
	078.001	Burkhead & Branch	2 of 2	2,611.35	6,267.98
	111.001	Cheshire 21 & Gillespie	1 of 1	1,390.00	10,112.66
	113.001	Cheshire #23	1 of 1	1,252.50	6,439.02
	245.001	Hartley	2 of 2	354.23	1,805.02
	363.900	Maxwell	1 of 1	1,000.00	0.00
	398.001	North State Road & Spaulding	1 of 1	174.30	234.05
	609.900	Salter	1 of 1	906.21	0.00
	481.001	Schultz	1 of 1	532.50	2,442.96
	538.001	Taylor	3 of 3	1,052.07	3,614.02
		CHESHIRE TOTAL		\$12,963.16	\$38,930.66

2019 ASSESSMENTS

TOWNSHIPS					
Township	Number	Drain Name	Year of Year	Amount at Large	Amount on Description
CLYDE	04				
	015.001	Aull	9 of 10	1,938.21	5,483.83
	174.001	Elm Creek	1 of 2	998.00	408.10
	185.001	Fennville-Billings	1 of 1	391.62	6,611.09
	398.001	North State Road/Spaulding	1 of 1	1,045.80	3,451.61
	401.001	Ockford	1 of 1	524.40	348.61
	426.001	Peterson	2 of 2	481.78	326.03
		CLYDE TOTAL		\$5,379.81	\$16,629.27
DORR	05				
	746.001	Arndt Plat	1 of 1	372.00	2,149.58
	085.001	Byron-Dorr Intercounty	1 of 1	2,848.00	18,751.69
	767.001	Dorr Commerce	1 of 1	588.00	3,698.82
	708.001	Dorr Meadows	2 of 2	243.47	1,568.10
	628.001	Jones	1 of 1	0.00	2,782.90
	820.001	Kay Drive	3 of 10	6,927.05	19,875.07
	377.001	Moline	8 of 10	4,898.96	10,125.36
	763.001	Sandy Hills	1 of 1	456.00	1,935.64
	500.001	Sink	1 of 1	897.40	4,734.00
	525.001	Steinke	1 of 1	753.20	4,432.90
	798.001	SunQuest Acres	1 of 1	872.40	5,125.50
	536.001	Tanner	2 of 3	499.33	2,962.62
	590.001-2	Weist	8 of 10	2,895.19	10,498.69
		DORR TOTAL		\$22,251.00	\$88,640.87
FILLMORE	06				
	168.001	East Fillmore	1 of 1	5,820.00	23,851.31
	178.001	Eskes & Ext.	1 of 1	770.00	3,590.00
	187.001	Fillmore #8	1 of 1	579.00	1,527.86
	311.001	Kuipers & Branch	1 of 1	259.60	2,017.10
	352.001	Maatman-Jaarda	3 of 5	10,735.37	52,857.71
	461.001	Rotman	1 of 1	1,515.50	7,678.28
	688.001	South Branch #5	1 of 1	1,670.40	15,291.52
		FILLMORE TOTAL		\$21,349.87	\$106,813.78

2019 ASSESSMENTS

TOWNSHIPS

Township	Number	Drain Name	Year of Year	Amount at Large	Amount on Description
GANGES	07				
	031.001	Beaver Dam	1 of 1	600.00	5,116.08
	174.001	Elm Creek	1 of 2	998.00	87.50
	371.001	Miller-McKeown	2 of 2	929.15	5,132.50
	398.001	North State Road & Spaulding	1 of 1	174.30	11.15
	401.001	Ockford	1 of 1	174.80	48.29
	819.001	Recreation	3 of 7	0.00	16,479.51
	483.001	Scott	3 of 3	816.53	1,979.69
	572.001	John Wadsworth	1 of 1	432.00	2,860.19
	817.001	Walker	5 of 10	0.00	19,796.81
		GANGES TOTAL		\$4,124.78	\$51,511.72
GUN PLAIN	08				
	234.001	Gun River Intercounty	1 of 1	2,600.84	18,927.53
	400.001	Nyberg	1 of 1	2,399.60	13,804.73
		GUN PLAIN TOTAL		\$5,000.44	\$32,732.26
HEATH	09				
		HEATH TOTAL		\$0.00	\$0.00
HOPKINS	10				
	067.001	Brown	1 of 1	330.00	1,981.19
	278.001	Hopkins Station	5 of 10	0.00	121.86
	309.001	Krug	1 of 1	192.50	639.73
	431.001	Pierce & Ext	1 of 1	453.60	1,972.60
	453.001	Ring & Perkins	3 of 7	2,244.75	4,124.20
	492.001	Selkirk & Sprague	1 of 1	937.30	4,794.00
		HOPKINS TOTAL		\$4,158.15	\$13,633.58

2019 ASSESSMENTS

TOWNSHIPS					
Township	Number	Drain Name	Year of Year	Amount at Large	Amount on Description
LAKETOWN	11				
	093.001	Carver	1 of 1	2,961.49	0.00
	220.001	Golf	7 of 10	0.00	0.00
	761.001	Heritage Meadow	1 of 1	4,607.42	0.00
	296.903	Kelly Lake Intercounty	5 of 15	53,325.18	0.00
	311.001	Kuipers & Branch	1 of 1	3,569.50	0.00
	715.001	Laketown Village	1 of 1	5,000.00	0.00
	754.001	Prins Acres	1 of 1	5,418.04	0.00
	712.001	Tanglewood	1 of 1	4,597.53	0.00
	570.001	Virginia Park Intercounty- Main	8 of 10	18,449.60	0.00
	570.200	Virginia Park Intercounty- Pine Hollow	8 of 10	1,941.61	6,039.20
		LAKETOWN TOTAL		\$99,870.37	\$6,039.20
LEE	12				
	690.001	Base Line Lake Intercounty	1 of 2	207.87	1,149.40
	070.001	Brush Creek Intercounty	1 of 1	1,700.00	8,566.21
	077.001	Burch & Phillips	2 of 2	3,187.87	11,323.04
	077.002	Burch & Phillips	1 of 1	0.00	1,183.50
	078.001	Burkhead & Branch	2 of 2	2,611.35	4,154.77
	137.900	Dailey	1 of 1	500.00	0.00
	139.001	Dalrymple	3 of 3	0.00	143.98
	155.001	Dokey	1 of 2	952.50	5,209.47
	174.001	Elm Creek	1 of 2	1,996.00	3,080.48
	196.001	Flora No 2	5 of 10	3,642.27	13,261.67
	318.001	Lee	5 of 10	5,530.32	27,943.79
	398.001	North State Road/Spaulding	1 of 1	871.50	2,251.83
	401.001	Ockford	1 of 1	437.00	1,059.76
	412.001	Oxley	3 of 3	0.00	1,303.93
	426.001	Peterson	2 of 2	1,284.75	5,517.60
	484.200	Scott Creek	8 of 10	4,869.17	23,716.12
		LEE TOTAL		\$27,790.60	\$109,865.55

2019 ASSESSMENTS

TOWNSHIPS						
Township	Number	Drain Name	Year of Year	Amount at Large	Amount on Description	
LEIGHTON	13					
	085.001	Byron-Dorr Intercounty	1 of 1	1,068.00	530.86	
	214.001	Gilbert-Wademan	7 of 10	5,148.00	15,557.57	
	291.001	Johnson	1 of 1	1,641.60	10,858.60	
	628.001	Jones	1 of 1	396.00	0.00	
	322.001	Leighton #1	1 of 1	461.76	3,271.50	
	377.001	Moline	8 of 10	0.00	27,812.68	
	553.001	Tollenaar	1 of 1	0.00	18,767.96	
		LEIGHTON TOTAL		\$8,715.36	\$76,799.17	
MANLIUS	14					
	185.001	Fennville-Billings	1 of 1	391.62	4,036.74	
	352.001	Maatman-Jaarda	3 of 5	3,578.46	1,550.68	
	688.001	South Branch #5	1 of 1	41.76	285.36	
		MANLIUS TOTAL		\$4,011.84	\$5,872.78	
MARTIN	15					
	135.001	Culver	1 of 1	760.00	5,473.25	
	232.001	Greggs Brook	1 of 1	378.00	2,022.59	
	234.001	Gun River Intercounty	1 of 1	2,600.84	20,381.75	
	816.001	Selkirk Lake	3 of 20	3,121.60	2,262.47	
		MARTIN TOTAL		\$6,860.44	\$30,140.06	
MONTEREY	16					
	123.001	Coffey	7 of 10	7,132.25	20,876.59	
	825.001	Dumont Lake Level Control	3 of 10	973.19	6,138.79	
	182.001	Felts	1 of 1	913.00	6,491.75	
	278.001	Hopkins Station	5 of 10	465.58	121.86	
	309.001	Krug	1 of 1	385.00	2,062.11	
		MONTEREY TOTAL		\$9,869.02	\$35,691.10	

2019 ASSESSMENTS

TOWNSHIPS

Township	Number	Drain Name	Year of Year	Amount at Large	Amount on Description
OTSEGO	17				
	021.001	Baseline Intercounty	1 of 2	823.50	116.40
	057.001	Brainard & Pease	2 of 3	1,328.56	6,679.44
	637.900	Casey & Closs	1 of 1	883.26	0.00
	198.001	Fox	1 of 1	327.50	1,291.11
	234.001	Gun River Intercounty	1 of 1	0.00	1,768.07
	280.001	Hubbard Intercounty	2 of 2	1,620.00	6,072.70
	320.001	Leighton	2 of 2	597.66	3,156.71
	503.001	Slater #17	1 of 1	0.00	67.36
	575.001	Waldron	1 of 1	345.00	1,906.81
		OTSEGO TOTAL		\$5,925.48	\$21,058.60
OVERISEL	18				
	123.001	Coffey	7 of 10	0.00	0.00
	168.001	East Fillmore	1 of 1	3,880.00	12,144.89
	178.001	Eskes & Extension	1 of 1	770.00	2,155.35
	210.001	Geib	1 of 1	867.60	1,783.86
	688.001	South Branch #5	1 of 1	208.80	1,711.37
	537.001	Tanis	1 of 1	438.00	3,130.60
	554.001	Top	1 of 1	1,608.00	11,045.36
		OVERISEL TOTAL		\$7,772.40	\$31,971.43
SALEM	19				
	038.001	Berens	1 of 1	396.00	2,768.06
	085.001	Byron-Dorr Intercounty	1 of 1	1,780.00	8,747.07
	123.001	Coffey	7 of 10	5,943.54	5,996.94
	182.001	Felts	1 of 1	365.20	961.61
	195.001	Fleser & Snyder	2 of 3	756.36	5,405.09
	210.001	Geib	1 of 1	2,024.40	9,228.58
	797.001	Oakland Hills	1 of 1	660.00	3,781.86
	482.001	Schumaker	4 of 10	10,757.20	44,723.30
	719.001	Summer Creek Est. No. 2	2 of 2	203.37	1,083.40
	590.001-2	Weist	8 of 10	1,447.60	1,645.26
		SALEM TOTAL		\$24,333.67	\$84,341.17

2019 ASSESSMENTS

TOWNSHIPS						
Township	Number	Drain Name	Year of Year	Amount at Large	Amount on Description	
SAUGATUCK	20					
	717.001	Amity Lane	1 of 1	0.00		0.00
	220.001	Golf	7 of 10	4,879.47		13,079.10
	288.001	Jager Crane	5 of 10	715.82		593.55
	369.001	Section #20 Interceptor	1 of 1	813.60		5,333.14
	572.001	John Wadsworth	1 of 1	0.00		189.29
	581.001	Warnock & Ext.	4 of 10	11,173.95		6,969.45
		SAUGATUCK TOTAL		\$17,582.84		\$26,164.53
TROWBRIDGE	21					
	016.001	Austin & Branch	1 of 1	1,080.00		3,714.54
	021.001	Baseline Intercounty	1 of 2	823.50		4,952.83
	022.001	Baseline Lake	1 of 1	585.00		2,898.00
	111.001	Cheshire 21 & Gillespie	1 of 1	278.00		1,589.74
	118.001	Clair	2 of 2	980.89		6,452.33
	198.001	Fox	1 of 1	196.50		416.55
	503.001	Slater #17	1 of 1	1,029.00		5,946.81
	575.001	Waldron	1 of 1	345.00		751.01
	577.001	Ward Extension & Branch	7 of 10	2,511.88		14,536.46
		TROWBRIDGE TOTAL		\$7,829.77		\$41,258.27
VALLEY	22					
	398.001	North State Road & Spaulding	1 of 1	174.30		22.88
	481.001	Schultz	1 of 1	532.50		1,603.62
		VALLEY TOTAL		\$706.80		\$1,626.50
WATSON	23					
	067.001	Brown	1 of 1	165.00		637.75
	090.001	Carlson	1 of 1	750.00		4,034.92
	198.001	Fox	1 of 1	262.00		660.84
	234.001	Gun River Intercounty	1 of 1	325.10		25.68
		WATSON TOTAL		\$1,502.10		\$5,359.19

2019 ASSESSMENTS

TOWNSHIPS					
Township	Number	Drain Name	Year of Year	Amount at Large	Amount on Description
WAYLAND	24				
	134.001	Cuddy Intercounty	4 of 15	0.00	39,070.82
	232.001	Greggs Brook	1 of 1	378.00	3,219.21
	234.001	Gun River Intercounty	1 of 1	1,950.63	10,852.13
	271.001	Holbrook & Branch	2 of 2	0.00	4,418.12
	668.001	Jackson	1 of 1	982.80	5,744.38
	431.001	Pierce & Extension	1 of 1	453.60	623.12
	807.001	Sandy Beach Intercounty	9 of 10	959.04	3,315.14
	492.001	Selkirk & Sprague	1 of 1	576.80	5,614.66
	816.001	Selkirk Lake	3 of 20	0.00	87,677.77
		WAYLAND TOTAL		\$5,300.87	\$160,535.35
GRAND TOTAL DUE				\$339,850.61	\$1,136,045.00

**2019
ASSESSMENTS**

CITIES

City	Number	Drain Name	Year of Year	Amount at Large	Amount on Description
DOUGLAS (59)					
	717.001	Amity Lane	1 of 1	600.00	3,300.89
	288.001	Jager Crane	5 of 10	3,579.11	25,301.06
	581.001	Warnock & Ext.	4 of 10	33,521.83	42,814.82
		Douglas Total		\$37,700.94	\$71,416.77
FENVILLE (52)					
	015.001	Aull	9 of 10	0.00	192.89
	185.001	Fennville-Billings	1 of 1	391.62	6,862.28
	756.001	Glenn View	1 of 1	588.00	4,312.00
	742.001	Paradise Woods Estates	1 of 1	380.40	2,789.60
		Fennville Total		\$1,360.02	\$14,156.77
HOLLAND (53)					
	187.001	Fillmore #8	1 of 1	579.00	2,999.80
	352.001	Maatman-Jaarda	3 of 5	1,789.23	885.30
	461.001	Rotman	1 of 1	216.50	502.93
	688.001	South Branch #5	1 of 1	125.28	146.13
		Holland Total		\$2,710.01	\$4,534.16
OTSEGO (54)					
	234.001	Gun River Intercounty	1 of 1	0.00	10.00
		Otsego Total		\$0.00	\$10.00
PLAINWELL (55)					
	234.001	Gun River Intercounty	1 of 1	975.31	944.63
		Plainwell Total		\$975.31	\$944.63
SAUGATUCK (57)					
	220.001	Golf	7 of 10	975.89	982.63
	581.001	Warnock & Ext.	4 of 10	0.00	168.74
		Saugatuck Total		\$975.89	\$1,151.37
WAYLAND (56)					
	492.001	Selkirk & Sprague	1 of 1	252.35	1,217.86
		Wayland Total		\$252.35	\$1,217.86
GRAND TOTAL DUE				\$43,974.52	\$93,431.56

**2019
ASSESSMENTS**

VILLAGES

Village	Number	Drain Name	Year of Year	Amount at Large	Amount on Description
MARTIN (42)					
	135.001	Culver	1 of 1	760.00	368.21
	234.001	Gun River Intercounty	1 of 1	325.10	265.08
		Martin Total		\$1,085.10	\$633.29
HOPKINS (44)					
	067.001	Brown	1 of 1	66.00	0.00
	278.001.1	Hopkins Station	5 of 10	2,793.07	13,039.02
	309.001	Krug	1 of 1	192.50	206.84
		Hopkins Total		\$3,051.57	\$13,245.86
GRAND TOTAL DUE				\$4,136.67	\$13,879.15

2019 ASSESSMENTS

STATE HIGHWAYS				
STATE HIGHWAY (91)	Number	Drain Name	Year of Year	Amount
	022.001	Baseline Lake	1 of 1	109.36
	085.001	Byron-Dorr Intercounty	1 of 1	191.92
	118.001	Clair	2 of 2	353.20
	168.001	East Fillmore	1 of 1	125.62
	178.001	Eskes	1 of 1	12.09
	185.001	Fennville-Billings	1 of 1	473.47
	232.001	Greggs Brook	1 of 1	18.96
	234.001	Gun River Intercounty	1 of 1	459.05
	271.001	Holbrook	2 of 2	85.68
	311.001	Kuipers & Branch	1 of 1	303.86
	400.001	Nyberg	1 of 1	369.71
	431.001	Pierce	1 of 1	137.68
	461.001	Rotman	1 of 1	488.97
	492.001	Selkirk & Sprague	1 of 1	402.19
	503.001	Slater #17	1 of 1	11.13
	688.001	South Branch #5	1 of 1	100.64
	577.001	Ward Extension & Branch	7 of 10	146.29
GRAND TOTAL DUE				\$3,789.82

2019 ASSESSMENTS

RAILROADS				
RAILROAD NAME	Number	Drain Name	Year of Year	Amount
CSX RAILROAD (92)				
	318.001	Lee	5 of 10	1,228.96
	352.001	Maatman-Jaarda	3 of 5	870.85
	688.001	South Branch #5	1 of 1	313.20
		CSX Railroad Total		\$2,413.01
GRAND ELK (95)				
	816.001	Selkirk Lake	3 of 20	2,300.15
		Grand Elk Railroad Total		\$2,300.15
NORFOLK SOUTHERN (94)				
	234.001	Gun River Intercounty	1 of 1	139.66
	377.001	Moline	8 of 10	2,800.57
	492.001	Selkirk & Sprague	1 of 1	132.66
		Norfolk Southern Total		\$3,072.89
CHS (99)				
	352.001	Maatman-Jaarda	3 of 5	408.45
		CHS Total		\$408.45
GRAND TOTAL DUE				\$8,194.50

2019 ASSESSMENTS

COUNTY AT LARGE AND COUNTY ROAD BENEFITS

Drain #	Drain Name	Township	Year of Year	Amount County at Large (00)	Amount County Roads (90)
717.001	Amity Lane	Saugatuck, Village of Douglas	1 of 1	549.56	549.55
746.001	Arndt Plat	Dorr	1 of 1	289.21	289.21
016.001	Austin & Branch	Cheshire, Trowbridge	1 of 2	152.76	152.76
017.001	Bailey-Bodfish & Branches	Casco	1 of 1	206.16	206.16
690.001	Base Line Lake Intercounty	Lee - VAN BUREN	1 of 2	14.28	14.28
021.001	Baseline Intercounty	Otsego, Trowbridge - VAN BUREN	1 of 2	73.16	73.16
022.001	Baseline Lake	Trowbridge	1 of 1	153.82	153.82
031.001	Beaver Dam	Ganges	1 of 1	141.96	141.96
038.001	Berens	Salem	1 of 1	67.97	67.97
057.001	Brainard & Pease	Otsego	2 of 3	159.07	159.07
060.001	Brennen	Cheshire	1 of 3	431.25	431.25
067.001	Brown	Hopkins, Watson, Hopkins Village	1 of 1	60.03	60.03
070.001	Brush Creek Intercounty	Cheshire, Lee - VAN BUREN	1 of 1	408.17	408.17
077.001	Burch & Phillips	Lee	2 of 2	487.90	487.90
078.001	Burkhead & Branch	Cheshire, Lee	2 of 2	337.68	337.68
085.001	Byron-Dorr Intercounty	Dorr, Leighton, Salem - KENT	1 of 1	841.23	841.23
090.001	Carlson	Watson	1 of 1	107.54	107.54
093.001	Carver	Laketown	1 of 1	69.25	69.25
637.900	Casey & Closs	Otsego	1 of 1	48.41	48.41
111.001	Cheshire 21 & Gillespie	Cheshire, Trowbridge	1 of 1	264.80	264.80
113.001	Cheshire #23	Cheshire	1 of 1	329.24	329.24
118.001	Clair	Trowbridge	2 of 2	105.61	105.61
135.001	Culver	Martin, Martin Village	1 of 1	119.27	119.27
139.001	Dalrymple	Casco, Lee	3 of 3	57.09	57.09
155.001	Dokey	Lee	1 of 2	94.05	94.05
767.001	Dorr Commerce	Dorr	1 of 1	306.59	306.59
708.001	Dorr Meadows	Dorr	2 of 2	108.65	108.65
168.001	East Fillmore	Fillmore, Overisel	1 of 1	1,339.09	1,339.09
174.001	Elm Creek	Casco, Clyde, Ganges, Lee	1 of 2	542.42	542.42
178.001	Eskes & Ext.	Fillmore, Overisel	1 of 1	201.28	201.28
182.001	Felts	Monterey, Salem	1 of 1	199.22	199.22
185.001	Fennville-Billings	Clyde, Manlius, Fennville	1 of 1	211.28	211.28

2019 ASSESSMENTS

COUNTY AT LARGE AND COUNTY ROAD BENEFITS

Drain #	Drain Name	Township	Year of Year	Amount County at Large (00)	Amount County Roads (90)
187.001	Fillmore #8	Fillmore, Holland City	1 of 1	52.17	52.17
195.001	Fleser & Snyder	Salem	2 of 3	141.50	0.00
198.001	Fox	Otsego, Trowbridge, Watson	1 of 1	60.25	60.25
210.001	Geib	Salem, Overisel	1 of 1	277.78	277.78
232.001	Greggs Brook	Martin, Wayland	1 of 1	141.62	141.62
234.001	Gun River Intercounty	Gun Plain/Martin/Otsego/Watson/Wayland/Martin/Otsego/Plainwell	1 of 1	1,234.75	1,234.75
245.001	Hartley	Cheshire	2 of 2	101.14	101.14
761.001	Heritage Meadows	Laketown	1 of 1	31.29	31.29
271.001	Holbrook & Branch	Wayland	2 of 2	83.65	83.65
280.001	Hubbard Intercounty	Otsego - KALAMAZOO	2 of 2	127.08	127.08
668.001	Jackson	Wayland	1 of 1	146.41	146.41
291.001	Johnson	Leighton	1 of 1	589.90	589.90
628.001	Jones	Dorr, Leighton	1 of 1	60.55	60.55
309.001	Krug	Hopkins, Monterey, Hopkins Village	1 of 1	85.66	85.66
311.001	Kuipers & Branch	Fillmore, Laketown	1 of 1	169.97	169.97
320.001	Leighton	Otsego	2 of 2	70.80	70.80
322.001	Leighton #1	Leighton	1 of 1	57.37	57.37
367.001	Miami Park	Casco	1 of 1	801.77	801.77
371.001	Miller-McKeown	Ganges	2 of 2	242.11	242.11
377.001	Moline	Dorr, Leighton	8 of 10	4,466.22	0.00
398.001	North State Road & Spaulding	Cheshire, Clyde, Ganges, Lee, Valley	1 of 1	151.64	151.64
400.001	Nyberg	Gun Plain	1 of 1	282.98	282.98
797.001	Oakland Hills	Salem	1 of 1	529.07	529.07
401.001	Ockford	Casco, Clyde, Ganges, Lee	1 of 1	149.19	149.19
412.001	Oxley	Casco, Lee	3 of 3	178.13	178.13
426.001	Peterson	Clyde, Lee	2 of 2	209.73	209.73
431.001	Pierce & Ext.	Hopkins, Wayland	1 of 1	69.70	69.70
754.001	Prins Acres	Laketown	1 of 1	220.98	220.98
819.001	Recreation	Ganges	3 of 7	2,706.01	0.00
757.001	Riverbend	Allegan	1 of 1	298.26	298.26
461.001	Rotman	Fillmore, Holland City	1 of 1	211.41	211.41
763.001	Sandy Hills	Dorr	1 of 1	704.18	704.18
481.001	Schultz	Cheshire, Valley	1 of 1	106.71	106.71
483.001	Scott	Casco, Ganges	3 of 3	42.81	42.81

2019 ASSESSMENTS

COUNTY AT LARGE AND COUNTY ROAD BENEFITS

Drain #	Drain Name	Township	Year of Year	Amount County at Large (00)	Amount County Roads (90)
369.001	Section #20 Interceptor	Saugatuck	1 of 1	316.63	316.63
492.001	Selkirk & Sprague	Hopkins, Wayland, Wayland City	1 of 1	246.09	246.09
785.001	Signal Point	Allegan	1 of 1	279.87	279.87
500.001	Sink	Dorr	1 of 1	389.30	389.30
503.001	Slater #17	Otsego, Trowbridge	1 of 1	147.85	147.85
688.001	South Branch #5	Fillmore, Manlius, Overisel, Holland City	1 of 1	492.77	492.77
515.001	Spencer Otis Dennis	Casco	2 of 2	92.73	92.73
525.001	Steinke	Dorr	1 of 1	96.95	96.95
719.001	Summer Creek Est. No. 2	Salem	2 of 2	34.50	34.50
798.001	SunQuest Acres	Dorr	1 of 1	636.05	636.05
712.001	Tanglewood	Laketown	1 of 1	301.24	301.24
537.001	Tanis	Overisel	1 of 1	40.70	40.70
536.001	Tanner	Dorr	2 of 3	52.36	52.36
538.001	Taylor	Cheshire	3 of 3	131.19	131.19
552.001	Tobin	Allegan	3 of 3	189.52	189.52
553.001	Tollenaar	Leighton	1 of 1	466.02	466.02
554.001	Top	Overisel	1 of 1	373.32	373.32
570.001	Virginia Park Intercounty- Main	Laketown - OTTAWA	8 of 10	1,780.69	0.00
572.001	John Wadsworth	Ganges, Saugatuck	1 of 1	59.26	59.26
575.001	Waldron	Otsego, Trowbridge	1 of 1	51.09	51.09
817.001	Walker	Ganges	5 of 10	3,955.74	0.00
590.001-2	Weist	Dorr, Salem	8 of 10	0.00	0.00
				\$33,414.66	\$20,364.49

GRAND TOTAL DUE

\$53,779.15

And I do Hereby Certify, that the foregoing embraces a full and true report of all the drains applied for, begun, constructed, or finished during the year now ended under the supervision of the Drain Commissioner, Denise Medemar, all of which is respectfully submitted.

Dated at Allegan, Michigan, this 23rd Day of April, 2020.



Denise Medemar
Allegan County Drain Commissioner

* * * * *

2019 ANNUAL REPORT
OF
DRAIN COMMISSIONER
COUNTY OF ALLEGAN
STATE OF MICHIGAN